



# USB-EXT11-KIT

## USB 5GBPS EXTENDER KIT 100M

The USB-EXT11-KIT is designed to transmit USB signals at speeds of up to 5Gbps over distances reaching 100 meters when utilizing a Cat6a cable. It maintains backward compatibility with earlier USB standards such as 1.1 and 2.0. The USB-EXT11-HOST acts as the host port within the extender kit, featuring a Type-C connection for the host device. Meanwhile, the USB-EXT11-CLIENT serves as the device port, offering four USB ports that can deliver a shared power output of 5V3A.

The devices feature a DIP switch that allows for the selection of two device power modes: Auto mode and Always On mode. In Auto mode, the power to the CLIENT side will automatically shut off when the host on the USB-EXT11-HOST side is disconnected. Conversely, when switched to Always On mode, the unit will continuously supply power, irrespective of the host's connection status.

This device is particularly ideal for extending USB connections for conferencing cameras, video capture devices, and audio equipment in boardrooms and conference environments. It also supports a diverse array of USB peripherals, including flash drives, hard drives, keyboards, mice, interactive whiteboards, touchscreens, audio devices, and other USB devices.

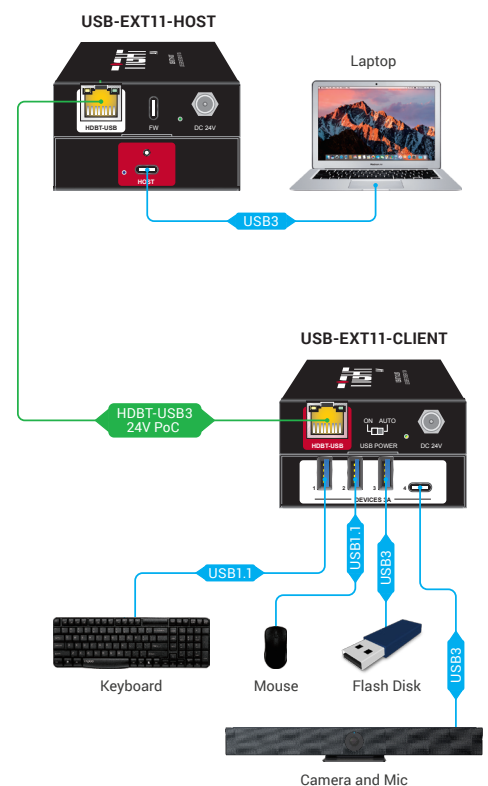

## KEY FEATURES

- USB data transfer rate up to 5Gbps.
- Supports extending USB signals up to 100m via Cat6a cable.
- Backwards compatible with USB 1.1 and USB 2.0
- Support USB device ports power management.
- Bi-directional 24V PoC power supply.

## TiGHT POLICY



**Faulty product - minimal down time.**

Up until six months after purchase, TiGHT AV will replace your product in advance of return of faulty product.

**Your investment - built to last.**

All TiGHT AV products come with a five year limited warranty.



## SPECIFICATIONS

### USB-EXT11-HOST

Host Connector:	(1) Type-C USB
USB Version:	USB 3.2 Gen1 (USB 5GBPS)
USB Compatibility:	USB 1.1/2.0/3.2 Gen1
FW Upgrade Port:	(1) Type-C USB
Dimension (W x H x D):	130.0 mm x 21.5 mm x 75.0 mm
Net Weight:	240g

### USB-EXT11-CLIENT

Device Connector:	(3) Type-A USB (1) Type-C USB
Device Power:	Devices share 15W (5V/3A)
USB Version:	USB 3.2 Gen1 (USB 5GBPS)
Dimension (W x H x D):	130.0 mm x 21.5 mm x 75.0 mm
Net Weight:	275 g

### CONTROL PART

Control Connector:	(1) 2-pin DIP switch
--------------------	----------------------

### GENERAL

Transmit distance:	Up to 100m with CAT6a cable
PoC standard:	Two-way 24V PoC
Max Data Rate:	5Gbps
Operation Temperature:	-10°C ~ +55°C
Storage Temperature:	-25°C ~ +70°C
Relative Humidity:	10% ~ 90%
External Power Supply:	DC 24V 1.5A
Max Power Consumption:	23.5W (fully populated)
Compliance:	FCC, CE
Environmental Compliance:	RoHS, REACH, WEEE

### PACKAGE LIST

• 1 x USB-EXT11-HOST	• 2 x Mounting Kit (Attached by default)
• 8 x Rubber feet	• 1 x User Manual
• 1 x USB-EXT11-CLIENT	• 1 x Power adapter (DC 24V1.5A) with EU & UK& US converter

### WARRANTY

• 5 years limited warranty
• 6 month advanced replacement policy

## PRODUCT IMAGES

### USB-EXT11-HOST



Front



Back

### USB-EXT11-CLIENT

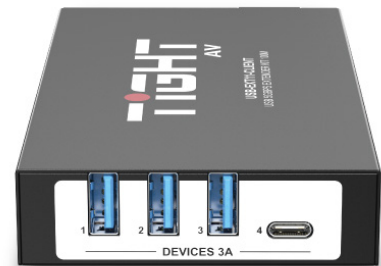

Front



Back

## KEY FEATURES

- USB data transfer rate up to 5Gbps.
- Supports extending USB signals up to 100m via Cat6a cable.
- Backwards compatible with USB 1.1 and USB 2.0
- Support USB device ports power management.
- Bi-directional 24V PoC power supply.

## TiGHT POLICY

**Faulty product - minimal down time.**

Up until six months after purchase, TiGHT AV will replace your product in advance of return of faulty product.

**Your investment - built to last.**

All TiGHT AV products come with a five year limited warranty.

