

User's Guide

ELPMB85

Rail Adapter

V12H006AX0

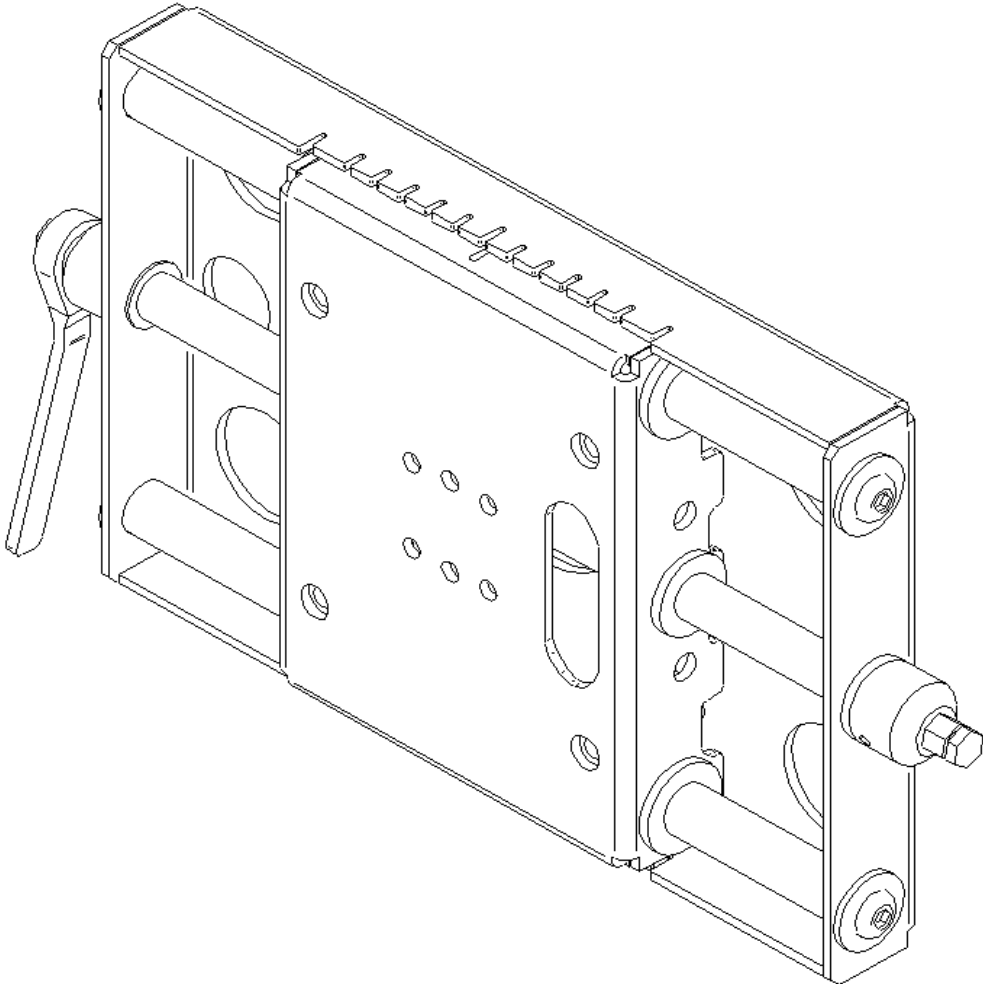

Safety Precautions

DANGER

- Failure to comply with these safety precautions results in death or serious injury;
- ELECTRICAL SHOCK HAZARD! Always turn off, disconnect, and disengage all power sources to the projector before servicing;

WARNING

Failure to comply with these safety precautions may result in serious injury.

- At least two qualified people should perform the installation procedure. Personal injury and/or property damage can result from dropping or mishandling the projector;
- If mounting to ceiling studs, make sure that the mounting screws are anchored into the center of the ceiling studs. Use of an edge-to-edge stud finder is recommended;
- Be aware of the mounting environment. If drilling and/or cutting into the mounting surface, always make sure that there are no electrical wires in the wall;
- Do not install near sources of high heat. Do not install on a structure that is prone to vibration, movement or chance of impact.

General information and compatibility

ELPMB85 is an optional which by its nature is always positioned between the attachment point and the cage to be fixed and/or adjusted, it's useful for the micrometric translation of a body from its fixing point.

It has 2 standard attachments compatible with all options or cages; in particular:

- 001: there are 4 M8 female threaded holes, arranged on the mobile face (therefore this side is only compatible with products that have the standard connection with through holes for M8 screws);
- 002: there are 4 through holes for M8 screws, arranged on the fixed face (therefore this side is only compatible with products that have the standard connection with M8 female threaded holes).

The nomenclature of "moving" or "fixed" face refers to the fact that the first one runs along fixed tracks, but despite this, the ELPMB85 can be fixed (to the ceiling or to a trellis) in both directions, as long as it works horizontally.

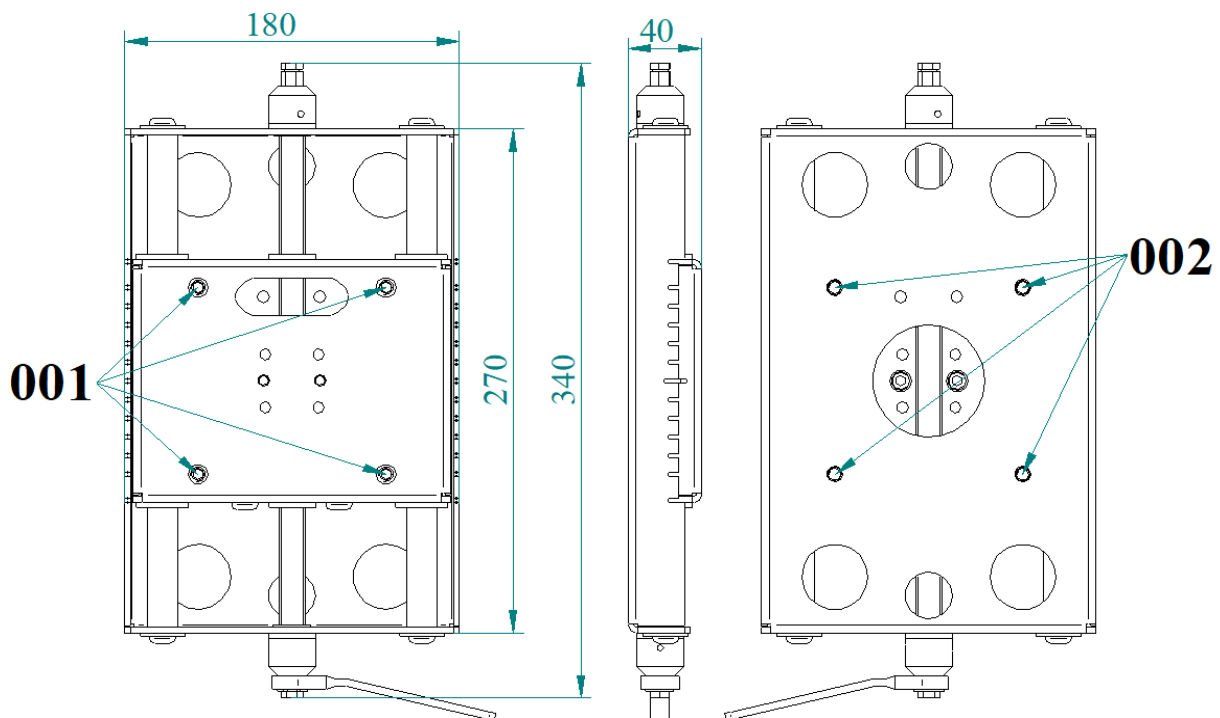

Use of ELPMB85

Once ELPMB85 has been assembled (see chapter 3) to use it, you have to:

2.1 - Rotate the ratchet wrench, present at one of the 2 ends so as to move the “moving” face with respect to the other face, in one of the 2 directions;

2.2 – If you want to reverse the sliding direction, just rotate the tab on the key and then repeat point 2.1.

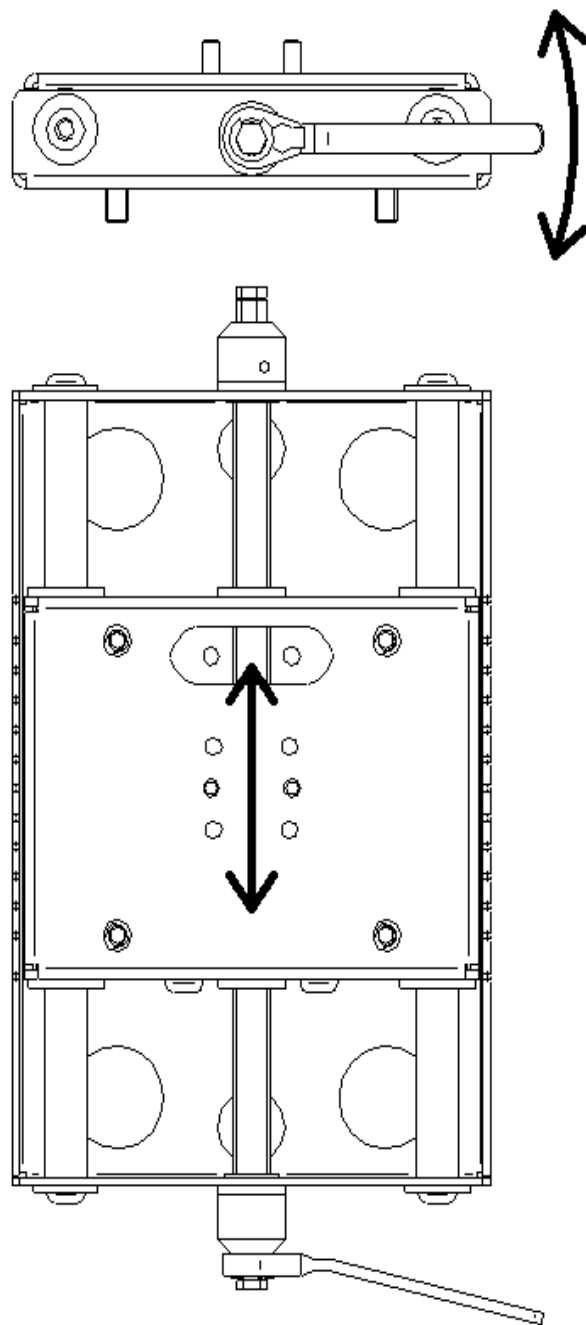

Assembly with other products

ASSEMBLY WITH “MOVING” FACE (001)

To fix the “moving” face to other product you have to:

3.1.1 – Apply a product equipped with 4 through holes for M8 screws with standard attachment (in the picture is shown a simple plate used only for illustrative purpose);

3.1.2 – Make sure that the 4 holes on both faces are coaxial with each other;

3.1.3 – Use screws with M8 thread that take into account:

- the depth of the thread in the Rail (consider a minimum of 10mm deep),
- the M8 washer,
- the thickness of the plate with through holes;

3.1.4 – Tighten the screws correctly.

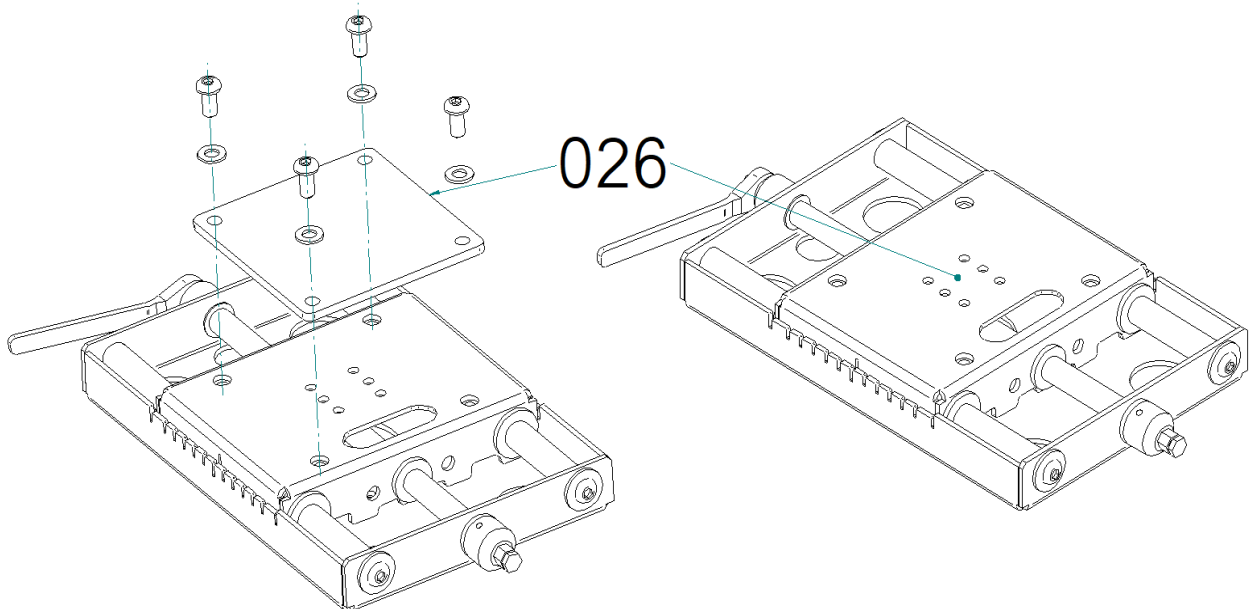

ASSEMBLY WITH “FIXED” FACE (002)

To fix the “fixed” face to other product you have to:

3.2.1 – Use the key and slide the “moving” face until completely revealing 2 of the 4 holes in the “fixed” one;

3.2.2 – Apply a product equipped with 4 M8 female thread holes with standard attachment (in the picture is shown a simple plate used only for illustrative purpose);

3.2.3 - Make sure that the 4 holes on both faces are coaxial with each other, so apply 2 screws (on the inside with respect to the folds) in the uncovered holes of the ELPMB85 “fixed” face, then tighten the 2 screws (without fully locking of the 2 sheets);

3.2.4 – Slide the mobile face as in point 3.2.2 but in the reverse direction, until the other 2 holes are discovered;

3.2.5 – Repeat point 3.2.3 for the other 2 holes;

3.2.6 – Reposition the “moving” face in the center, so that its 4 holes are coaxial with those of the fixed one;

3.2.7 - Use an Allen key, pass it through the 4 threaded holes of the “moving” face and tighten the 4 previous screws until they are completely locked.

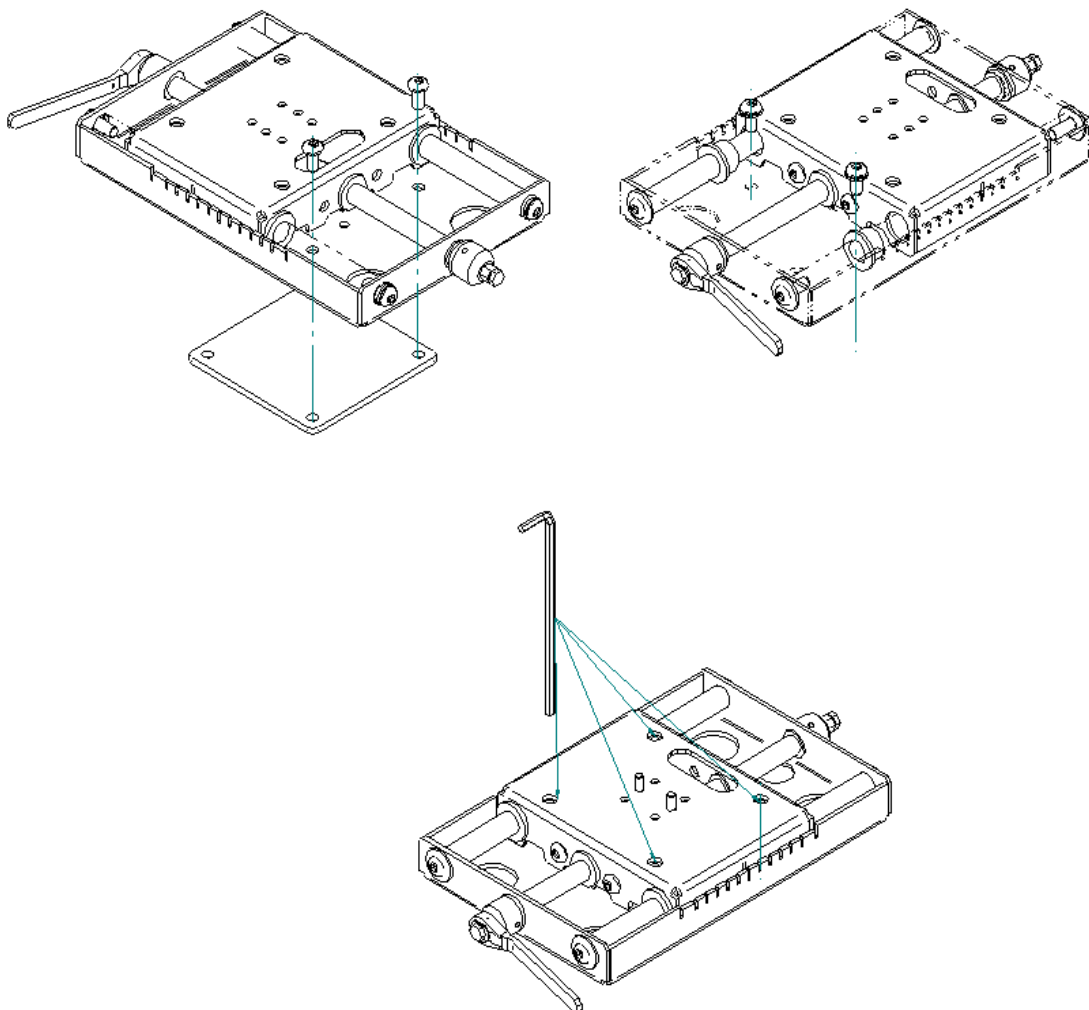

Rail is equipped with a standard double attachment compatible with all the main products (see chapter 3 to understand how to fix them to the Rail).

Here some examples with KOSMO:

A) ELPMB68 + ELPMB85

B) ELPMB85 + Single Clamp

C) ELPMB68 + ELPMB85 + Single Clamp

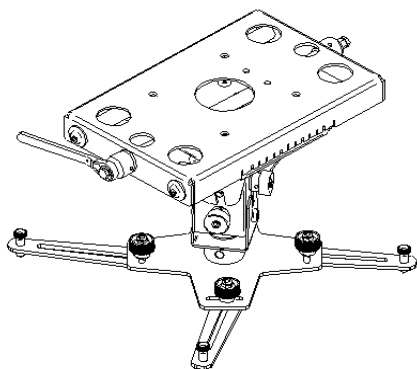

(A)

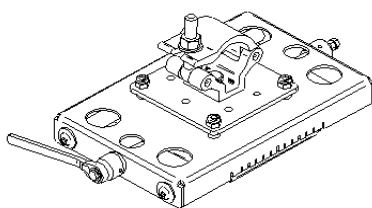

(B)

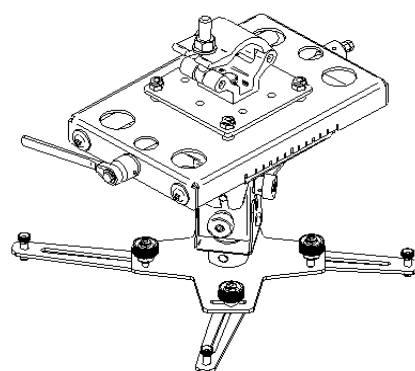

(C)

To fix the ELPMB68 to the ELPMB85 you have to:

4.1 – Remove the ELPMB68 plate (003)

4.2 – Fix the ELPMB68 on the face (004) in holes (005) using 2 M6 screw (use the allen key throught the circular holes 006)

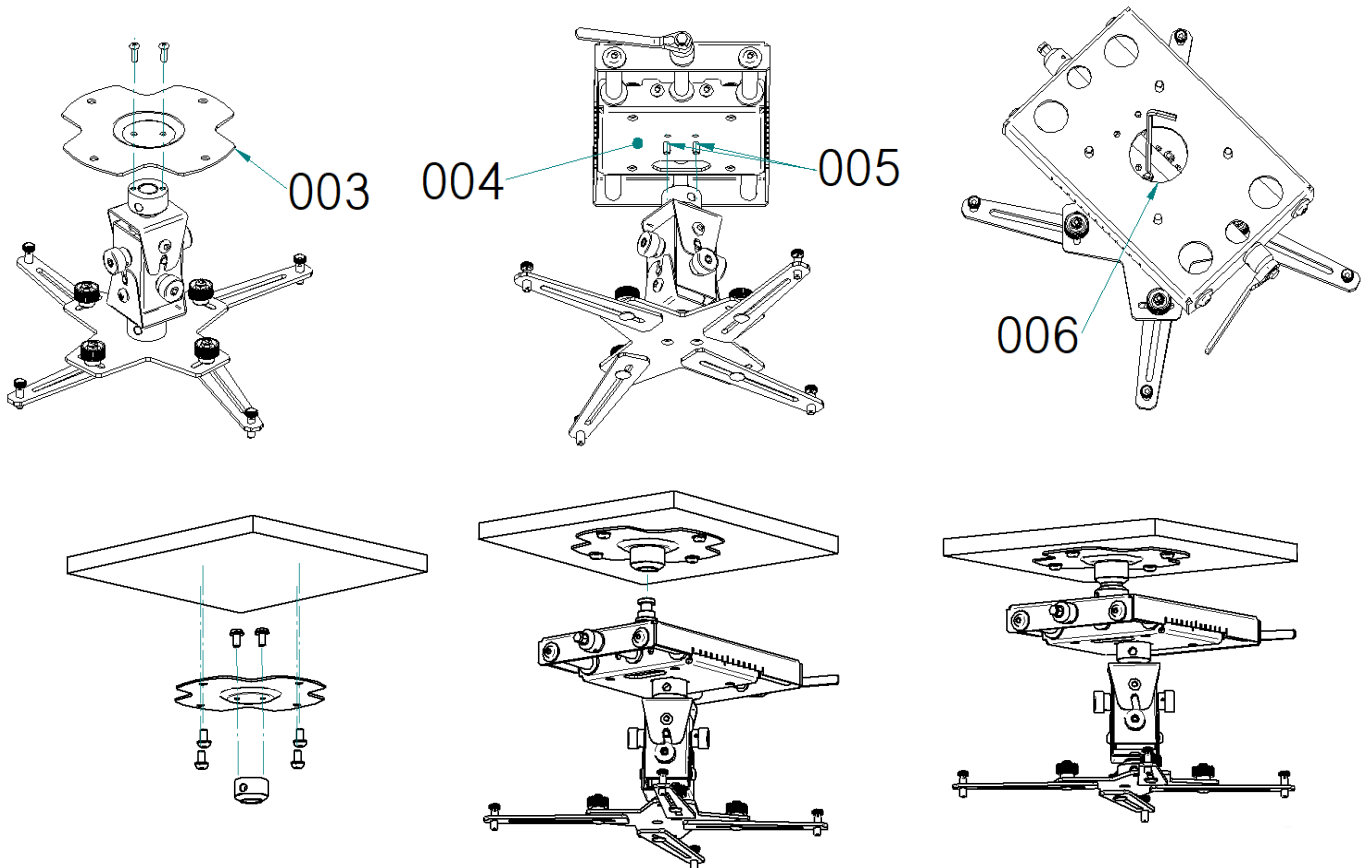
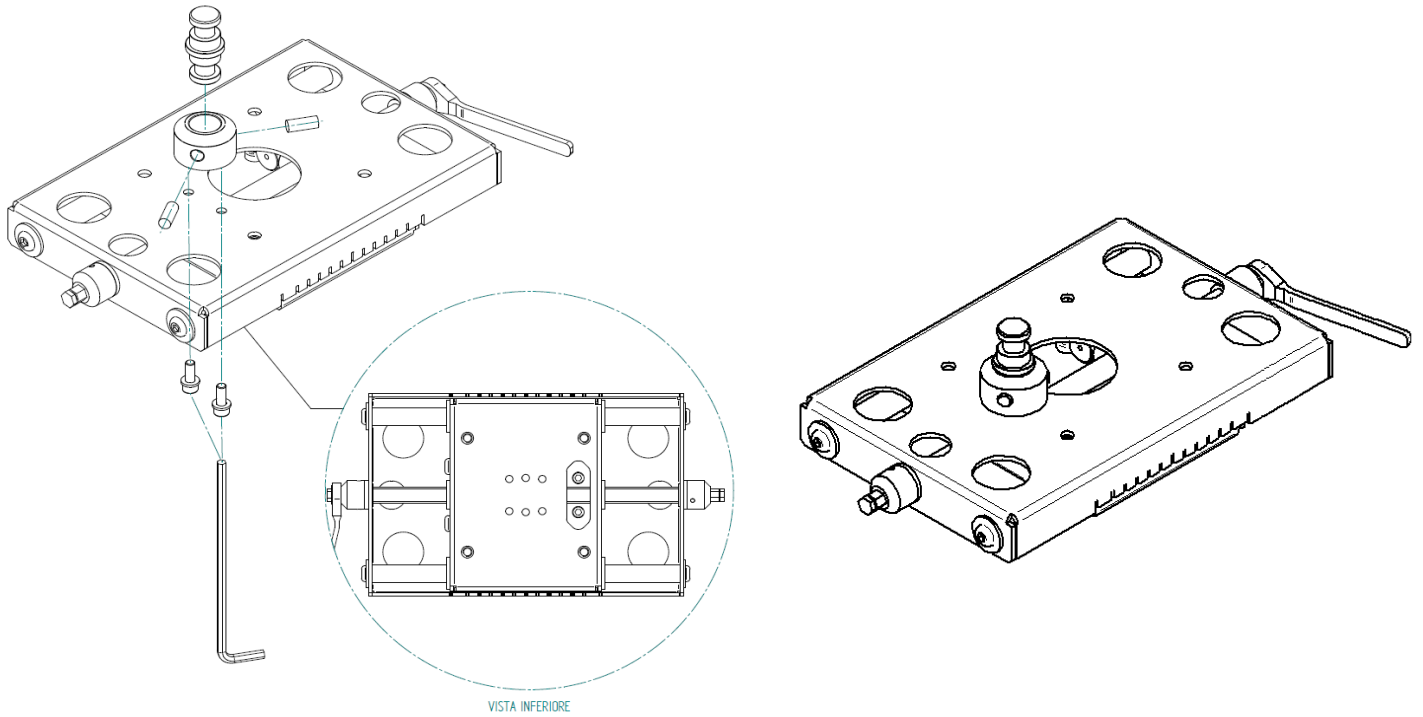

Maintenance

Do not try to service this product yourself, except as specifically explained in this User's Guide. Refer all other servicing to qualified service personnel.

HARDWARE'S INSPECTION

The ELPMB79 arm adapter does not require special maintenance, but a visual inspection must be conducted before each installation involving the system.

Please conduct a visual inspection to ensure that all screws are in the correct positions and none are missing.

Tighten any loose hardware as needed to maintain stability and prevent the risk of the projector falling or becoming misaligned.

Ensure that screws, nuts and all components are not bent, damaged, or broken.

Please use the appropriate tool to check that all screws are securely tightened.

If any parts are broken or missing, please contact the seller to obtain the necessary spare parts.

CLEANING

Use a soft, dry cloth to gently wipe down the mount's surfaces, removing any dust or dirt. For stubborn stains or dirt buildup, lightly dampen the cloth with water or a mild, non-abrasive cleaner.

Avoid using harsh chemicals that may damage the mount's finish. Ensure that the mount is completely dry before reattaching the projector to prevent any electrical issues.

LUBRICATION OF MOVING PARTS (IF APPLICABLE):

If the projector mount includes moving parts such as hinges or swivel mechanisms, apply a small amount of lubricant to ensure smooth operation.

Use a lubricant recommended by the manufacturer to prevent damage to the mount's components.

CONCLUSIONS

By following this maintenance plan, you can keep your mount adapter and in optimal condition, prolonging their lifespan and ensuring reliable performance for your presentations or entertainment needs.